



CMO VALVES
manufacturing the valve you need

31A SERIES



FABRICATION RANGE BALL CHECK VALVES

UTILIZATION:

- Ball check valves used to stop the return of the fluid in case of a lack of pressure, specially designed for dirty waters, viscous or loaded fluids.
- It is 100% water tight.

31 - SERIES

BALL CHECK VALVES



MAIN FEATURES:

- 100% water tight.
- Stainless steel bolts.
- Stainless steel purge plug.
- WRAS certificate for drinking water.
- Max. working pressure according to design pressure PN10/16.
- Working temperature between -10°C and 90°C.

STANDARDS APPLIED:

- Hydrostatic tests according to EN 12266-1, class A.
- EC Directive.
- Distance between flanges according to DIN 3202 F6.
- Side flanges according to ISO 7005-2.

DIMENSIONS

DN	L	H
50	200	115
65	240	124
80	260	138
100	300	162
125	350	202
150	400	228
200	500	298
250	600	368
300	700	438
400	900	584
500	1100	740

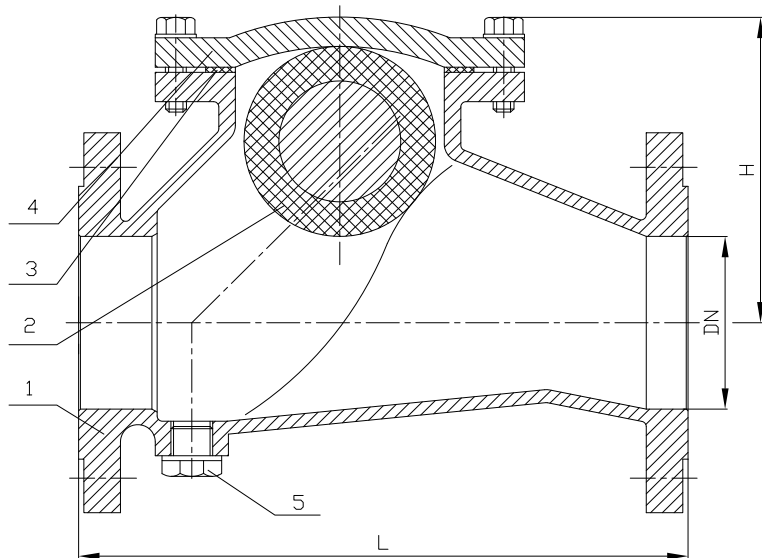

DESCRIPTION

1	BODY	GJS500
2	BALL	STEEL + EPDM
3	GASKET	NBR
4	BONNET	GJS500
5	PURGE PLUG	AISI 304
	BOLTS	A2
	PAINTING RAL 5015	Epoxy 250 µm

The images and drawings are non contractual.
The specifications of the shown products could vary without previous notice.

31 - SERIES

BALL CHECK VALVES

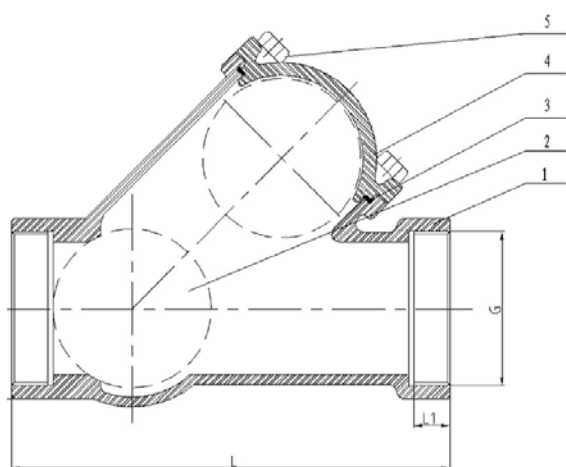

DESCRIPTION

1	BODY	GJS500
2	BALL	STEEL + EPDM
3	GASKET	NBR
4	BONNET	GJS500
5	BOLTS	A2
PAINTING RAL 5015		Epoxy 250 µm

DIMENSIONS

DN	L	G	L1	Weight
32	140	1.25"	21.4	2,0
40	145	1.5"	21.4	2,5
50	170	2"	25.7	3,5
65	210	2.5"	30.2	6,0
80	240	3"	33.3	8,0

